

LEGEND

	BENCHMARK
	EX. MONUMENT WELL
	EX. MONUMENTS
	EX. SET MONUMENT
101.97 C	EX. CONCRETE ELEVATION
101.39 FL	EX. FLOWLINE OF CURB ELEVATION
101.39 BSW	EX. BACK OF SIDEWALK ELEVATION
101.14 P	EX. PAVEMENT ELEVATION
101.5	EX. GROUND ELEVATION
---	PROPERTY LINE
---	CENTERLINE
---	EX. FENCE
8" SS	EX. SANITARY SEWER PIPELINE
18" SD	EX. STORM DRAIN PIPELINE
12" W	EX. WATER PIPELINE
SSMH	EX. SANITARY SEWER MANHOLE
SDMH	EX. STORM DRAIN MANHOLE
W	EX. WATER VALVE
W	EX. WATER WELL
W	EX. NON-POTABLE WATER VALVE
MH	EX. MANHOLE
TMH	EX. TELEPHONE MANHOLE
PMH	EX. PRESSURE MANHOLE
SSCO	EX. SANITARY SEWER CLEAN OUT
FH	EX. FIRE HYDRANT
GV	EX. GAS VALVE
CB	EX. CATCH BASIN
DI	EX. DRAIN INLET
HW	EX. TRAFFIC SIGNAL HAND WELL
LD	EX. TRAFFIC SIGNAL LOOP DETECTOR
GP	EX. BOLLARD
SL	EX. LIGHT
SL	EX. STREET LIGHT
SG	EX. SIGN
PP	EX. POWER POLE
TP	EX. TELEPHONE POLE
JP	EX. JOINT UTILITY POLE
GP	EX. GUY POLE
SP	EX. UTILITY SERVICE POLE
C	EX. TREE
E	EX. CABLE CHRISTY BOX
E	EX. ELECTRICAL CHRISTY BOX
F	EX. FIRE ALARM CHRISTY BOX
G	EX. GAS CHRISTY BOX
I	EX. IRRIGATION CHRISTY BOX
L	EX. STREET LIGHT CHRISTY BOX
M	EX. COMMUNICATION CHRISTY BOX
R	EX. TRAFFIC CHRISTY BOX
S	EX. IRRIGATION CONTROL VALVE BOX
T	EX. TELEPHONE CHRISTY BOX
U	EX. UTILITY CHRISTY BOX
W	EX. WATER CHRISTY BOX
10" SS	PROP. SANITARY SEWER PIPELINE
18" SD	PROP. STORM DRAIN PIPELINE
12" W	PROP. WATER PIPELINE
12" RW	PROP. NON-POTABLE WATER PIPELINE
SMH~1	PROP. SEPARATION MANHOLE
SDMH~1	PROP. STORM DRAIN MANHOLE
DI~1	PROP. CATCH BASIN
SSCO~1	PROP. DROP INLET
SSMH~1	PROP. SANITARY SEWER CLEAN OUT
W	PROP. SANITARY SEWER MANHOLE
W	PROP. POTABLE WATER VALVE
W	PROP. NON-POTABLE WATER VALVE
W	PROP. FIRE HYDRANT
W	PROP. WATER BLOW-OFF ASSEMBLY
W	PROP. HOT MIX ASPHALT
W	PROP. CONCRETE

ABBREVIATIONS

C	CONCRETE
P	PAVEMENT
R	RADIUS
L	LENGTH
S	SLOPE
W	POTABLE WATER
OC	ON CENTER
BC	BEGINNING OF CURVE
EC	END OF CURVE
AC	ASPHALT CONCRETE
DI	DROP INLET
AV	AIR VENT
IV	IRRIGATION VALVE
AB	AGGREGATE BASE
SF	SQUARE FEET
CY	CUBIC YARD
RW	RIGHT-OF-WAY
PL	PROPERTY LINE
CL	CENTER LINE
FL	FLOWLINE
EP	EDGE OF PAVEMENT
TC	TOP OF CURB
EX	EXISTING
GB	GRADE BREAK
HP	HIGH POINT
LP	LOW POINT
AP	ANGLE POINT
UP	UTILITY POLE
PP	ELECTRICITY POLE
TP	TELEPHONE POLE
JP	JOINT UTILITY POLE
SP	SERVICE POLE
GP	GUY POLE
LF	LINEAR FOOT
CB	CATCH BASIN
SS	SANITARY SEWER
SD	STORM DRAIN
APN	ASSESSORS' PARCEL NUMBER
BSW	BACK OF SIDEWALK
INV	INVERT
HMA	HOT MIX ASPHALT
NPW	NON-POTABLE WATER
TYP	TYPICAL
PCC	POINT OF COMPOUND CURVE
PRC	POINT OF REVERSE CURVE
IDB	IRRIGATION DISTRIBUTION BOX
ISP	IRRIGATION STAND PIPE
PROP	PROPOSED
RHMA	RUBBERIZED HOT MIX ASPHALT
SSMH	SANITARY SEWER MANHOLE
SSCO	SANITARY SEWER CLEAN OUT
SDMH	STORM DRAIN MANHOLE

CONTACTS

CITY OF TURLOCK, DEVELOPMENT SERVICES DEPARTMENT (209) 668-5520 ENGINEERING DIVISION
CITY OF TURLOCK, MUNICIPAL SERVICES DEPARTMENT (209) 668-5590 FOR SEWER, STORM AND WATER LINES
TURLOCK IRRIGATION DISTRICT (ELECTRICAL) (209) 883-8419 ED JEFFERS
TURLOCK IRRIGATION DISTRICT (IRRIGATION) (209) 883-8367 TODD TROGLIN
CHARTER COMMUNICATIONS (209) 633-3311 ABEL DAVILA
PACIFIC GAS & ELECTRIC (GAS) (209) 576-6662 KURT SOUSA
AT&T (209) 549-5847 SHARON DINNELL
FIRE DEPARTMENT (NON-EMERGENCY) (209) 668-5580
POLICE DEPARTMENT (NON-EMERGENCY) (209) 668-1200
AMBULANCE (209) 632-2271
TURLOCK SCAVENGER (209) 668-7274

NOTE:
ALL REFERENCES AND WRITTEN
DIMENSIONS SHALL SUPERSEDE
ALL SCALED DISTANCES AND
SHALL BE VERIFIED IN THE
FIELD. ANY DISCREPANCY SHALL
BE BROUGHT TO THE ATTENTION
OF THE ENGINEER PRIOR TO
THE COMMENCEMENT OF WORK.

Stephen J. Jorgensen
STEPHEN FREMMING, P.E.
PRINCIPAL CIVIL ENGINEER
5/23/2023
PLANS APPROVAL DATE



CITY OF TURLOCK
PUBLIC WORKS DEPARTMENT
ENGINEERING DIVISION
156 S. BROADWAY, STE 150
(209) 668-5520

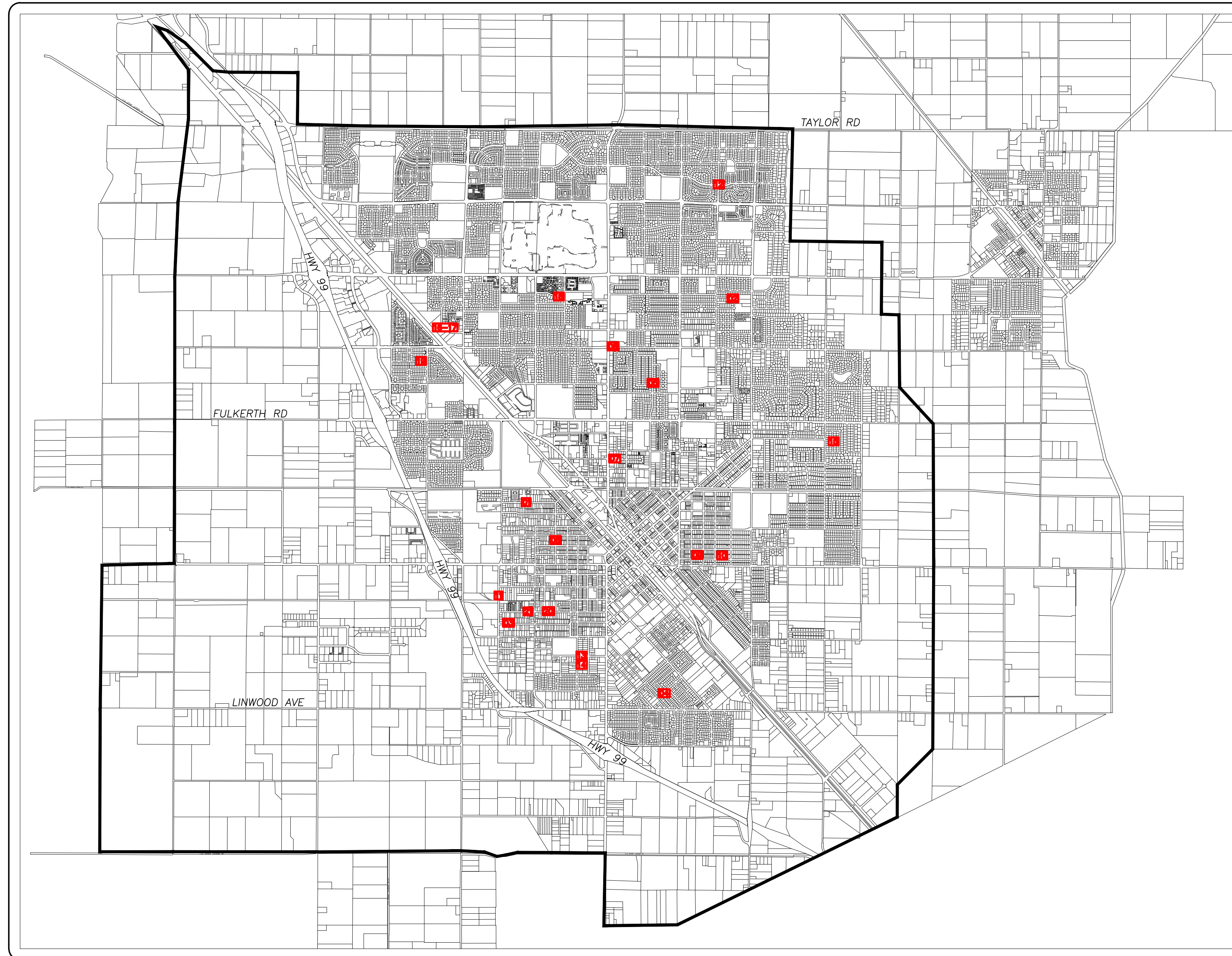

VICINITY MAP



SHEET INDEX

SHEET	DESCRIPTION
1	SHEET INDEX, LEGEND & VICINITY MAP
2	LOCATION PLAN & GENERAL NOTES
3	TRENCHES WITH IRREGULAR DIMENSIONS
4	CONSTRUCTION DETAILS

REVIEWED BY

Carlos Guerrero
CARLOS GUERRERO, UTILITIES MANAGER
5/23/23
DATE

PLAN SET APPROVED BY

NANDA K. GOTTIPARTHY
C-62308
CIVIL
NANDA K. GOTTIPARTHY, P.E.
ACTING CITY ENGINEER
5/30/2023
DATE



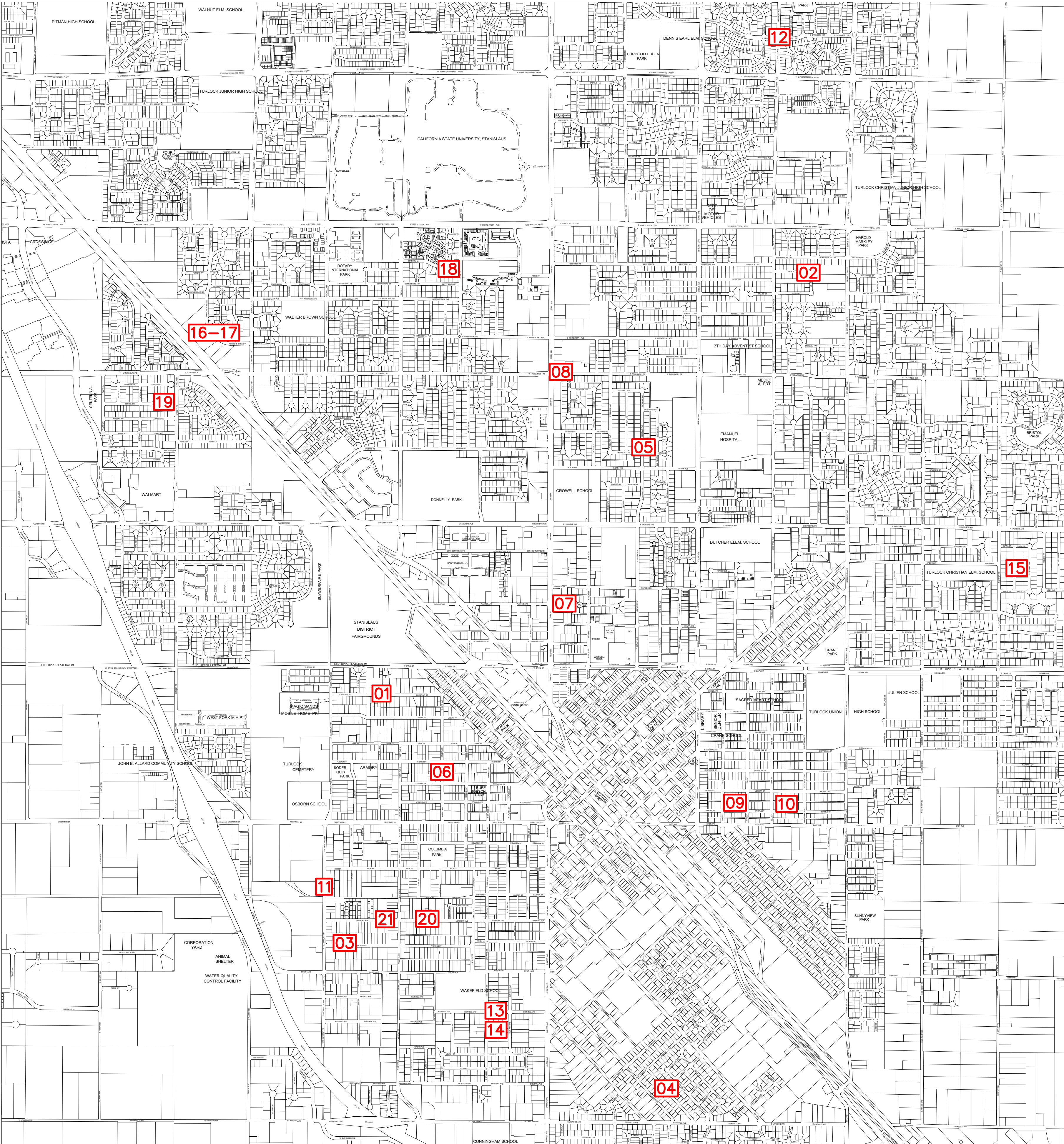

TRENCH LOCATIONS

ID #	LOCATION	UTILITY	DIA (IN)	LENGTH (FT)	WIDTH (FT)	TRENCH AREA (SQ FT)	GRIND/PAVE SURFACE AREA (SQ FT)
1	894 CHESTNUT ST	S	4	24	4	96	240
2	1360 AKRON DR	W	1	20	5	100	200
3	1039 ANGELUS ST	SS	4	18	5	90	180
4	1101 AMBERWOOD LN	SS	4	24	5	120	240
5	1935 N DENAIR AVE	SS	4	22	6	132	220
6	532 FLOWER (ON GRANT AVE)	SS	4	9	5	45	90
7	1002 GEER RD	W	2	10	5	50	100
8	2340 GEER RD (ON W TUOLUMNE)	W	2	9	5	45	90
9	1215 MYRTLE ST (IN ALLEY)	SS	4	15	2	30	0
10	1401 MYRTLE ST (IN ALLEY)	W	1	15	5	75	0
11	415 S SODERQUIST RD	W	1	27	4	108	270
12	1163 E SPRINGER DR	SS	4	54	3	162	648
13	376 BERNELL AVE	SS	4	REF SHEET 3		80	200
14	1003 BETHANY AVE	W	1	REF SHEET 3		82	150
15	1345 FOREST DR	W	1	REF SHEET 3		42	90
16	2500 N GOLDEN STATE (ON PORSCHE STRASSE)	W	1	REF SHEET 3		120	330
17	2500 N GOLDEN STATE (ON PORSCHE STRASSE)	SS	4	REF SHEET 3		80	200
18	540 SEABORG ST	W	1	REF SHEET 3		65	170
19	2144 SORREL DR	SS	4	REF SHEET 3		55	150
20	652 VERMONT AVE	SS	4	REF SHEET 3		35	100
21	831 VERMONT AVE	W	1	REF SHEET 3		40	250

NOTES:

1. TRENCH REPAIRS SHALL BE DONE IN ACCORDANCE WITH THE MODIFIED CITY DRAWINGS T-1 THROUGH T-3 AS SHOWN ON SHEET 4 OF THESE PLANS, AND SHALL COMPLY WITH ALL CITY OF TURLOCK STANDARDS. PER THE MODIFIED DRAWINGS T-1 AND T-2 THE CONTRACTOR SHALL EXCAVATE AND REMOVE EXISTING MATERIAL TO THE TOP OF PIPE.
2. TRENCH BACKFILL SHALL BE COMPACTED TO 95% BEFORE PLACING 6-INCH AB. COMPACTION TESTING WILL BE PROVIDED BY THE CITY. COORDINATE TESTING REQUESTS WITH CITY ENGINEERING INSPECTOR.
3. FOR BIDDING PURPOSES, CONTRACTOR SHALL ASSUME INVERT OF UTILITIES ARE LOCATED A MAXIMUM DEPTH OF 4 FEET BELOW EXISTING PAVEMENT AND THAT THE EXISTING DEPTH OF ASPHALT PAVEMENT IS 4 INCHES.
4. CONTRACTOR SHALL OBTAIN ENCROACHMENT PERMIT FROM THE CITY OF TURLOCK PRIOR TO BEGINNING WORK (NO FEE).
5. CONTRACTOR SHALL VERIFY DIMENSIONS AND CALCULATIONS OF ALL GRINDING AREAS BEFORE STARTING THE PROJECT.
6. CONTRACTOR SHALL COMPLY WITH ALL APPLICABLE STATE AND FEDERAL SAFETY AND LABOR CODES.
7. THE CONTRACTOR SHALL BE RESPONSIBLE FOR THE PRESERVATION AND PROTECTION OF ALL UNDERGROUND PIPES, CONDUITS AND OTHER IMPROVEMENTS. IT SHALL BE THE RESPONSIBILITY OF THE CONTRACTOR TO NOTIFY ALL UTILITY COMPANIES AT LEAST 48 HOURS PRIOR TO COMMENCEMENT OF WORK. CONTRACTOR SHALL NOTIFY:

A. UNDERGROUND SERVICE ALERT (USA) AT 1-800-227-2600 TO LOCATE EXACT POSITION OF UNDERGROUND TELEPHONE CABLE, GAS LINES, SEWER LINES AND WATER LINES.

B. TURLOCK IRRIGATION DISTRICT AT (209) 883-8464 TO LOCATE UNDERGROUND ELECTRICAL CONDUIT.

C. CHARTER CABLE AT (209) 656-2124 TO LOCATE UNDERGROUND CABLE T.V.

D. FIRE DEPARTMENT AT (209) 668-5580, POLICE DEPT. AT (209) 668-5550 AND AMBULANCE AT (209) 632-2271.
8. ANY UTILITY TO BE RELOCATED OR REMOVED SHALL BE COORDINATED WITH THE APPROPRIATE UTILITY COMPANY.
9. CITY CREWS WILL REPLACE PAVEMENT MARKINGS AND MARKERS.
10. ONE LANE SHALL REMAIN OPEN AT ALL TIMES. CONTRACTOR SHALL PROVIDE FLAG MEN DURING WORKING HOURS.
11. ALL TRENCHES SHALL BE BACKFILLED AND PAVED WITH TEMPORARY AC AT THE END OF THE WORK DAY.



NOTE:
ALL REFERENCES AND WRITTEN DIMENSIONS SHALL SUPERCEDE ALL SCALED DISTANCES AND SHALL BE VERIFIED IN THE FIELD. ANY DISCREPANCY SHALL BE BROUGHT TO THE ATTENTION OF THE ENGINEER PRIOR TO THE COMMENCEMENT OF WORK.

Stephen J. Fremming, P.E.
Principal Civil Engineer
5/23/2023
PLANS APPROVAL DATE

REGISTERED PROFESSIONAL ENGINEER
STEPHEN ROY FREMMING
No. 80224
CIVIL
STATE OF CALIFORNIA

CITY OF TURLOCK
PUBLIC WORKS DEPARTMENT
ENGINEERING DIVISION
156 S. BROADWAY, STE 150
(209) 668-5520

LOCATION PLAN & GENERAL NOTES
CAPITAL PROJECT NO. 21-023
CITY UTILITY TRENCH REPAIR – 2023

<div>VERIFY SCALE BAR IS 1" ON ORIGINAL DRAWING 1/4" 3/4" 1" 0 1/2"</div> <div>IF NOT ONE INCH ON THIS SHEET, ADJUST SCALES ACCORDINGLY</div>	DRAWN BY: JTL	SHEET <div>02</div> <div>OF 04</div>
	REV. BY: SRF	
	CH. BY: SRF	
	DATE: MAY 16, 2023	
	SCALE: NOT TO SCALE	
21-023 DRAWINGS.DWG		

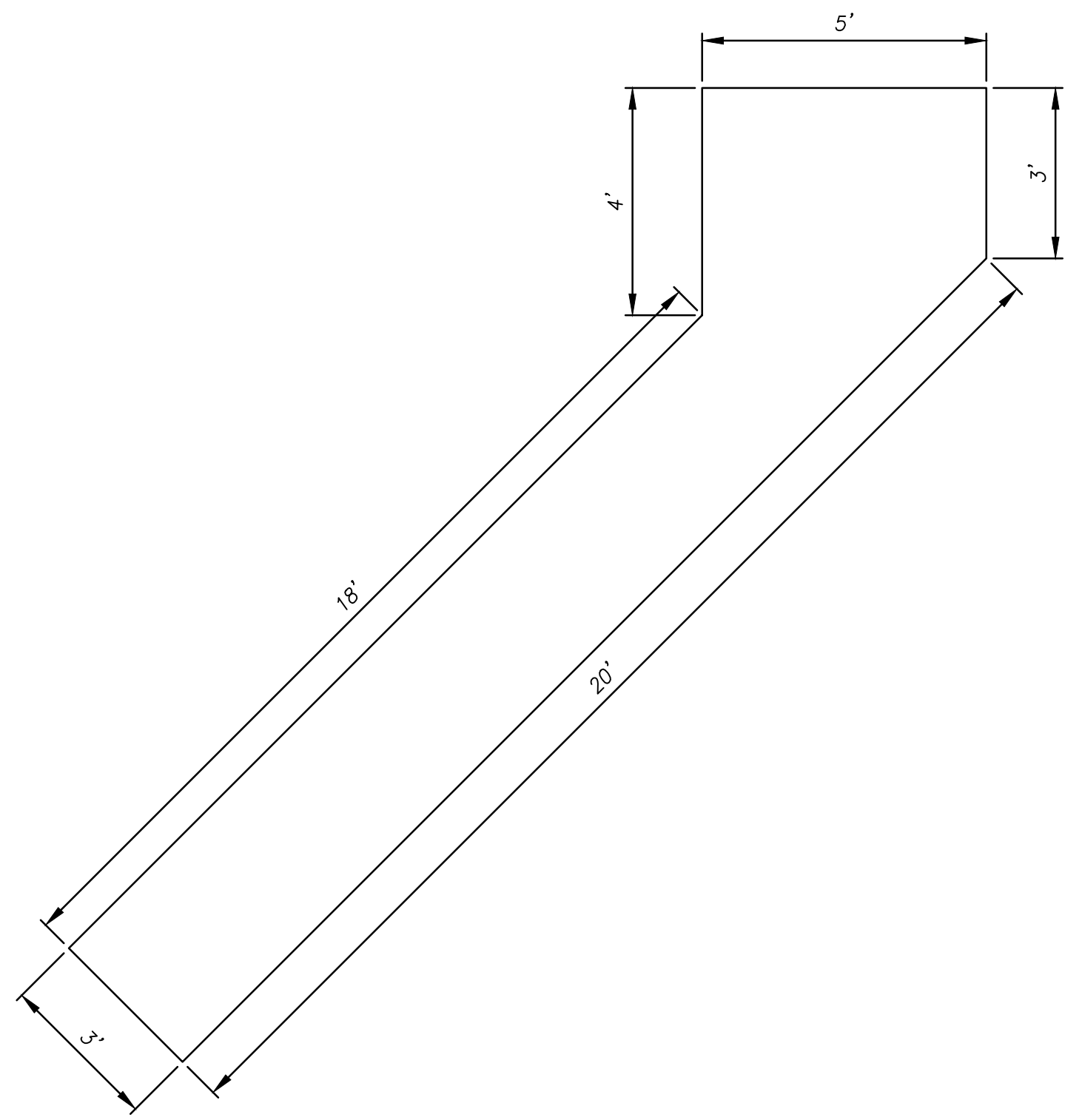

TRENCH #13 DIMENSIONS

NOT TO SCALE

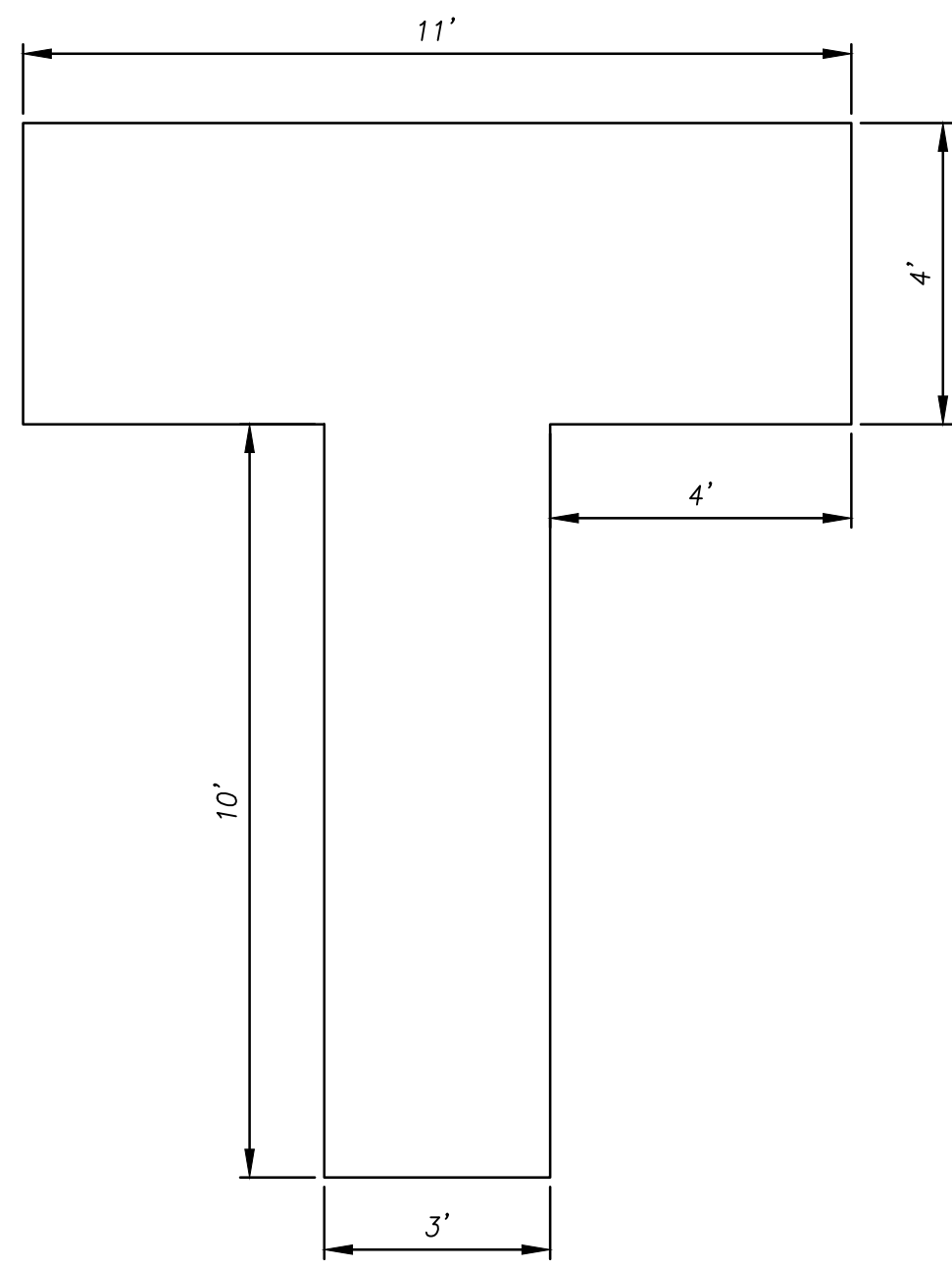

TRENCH #14 DIMENSIONS

NOT TO SCALE

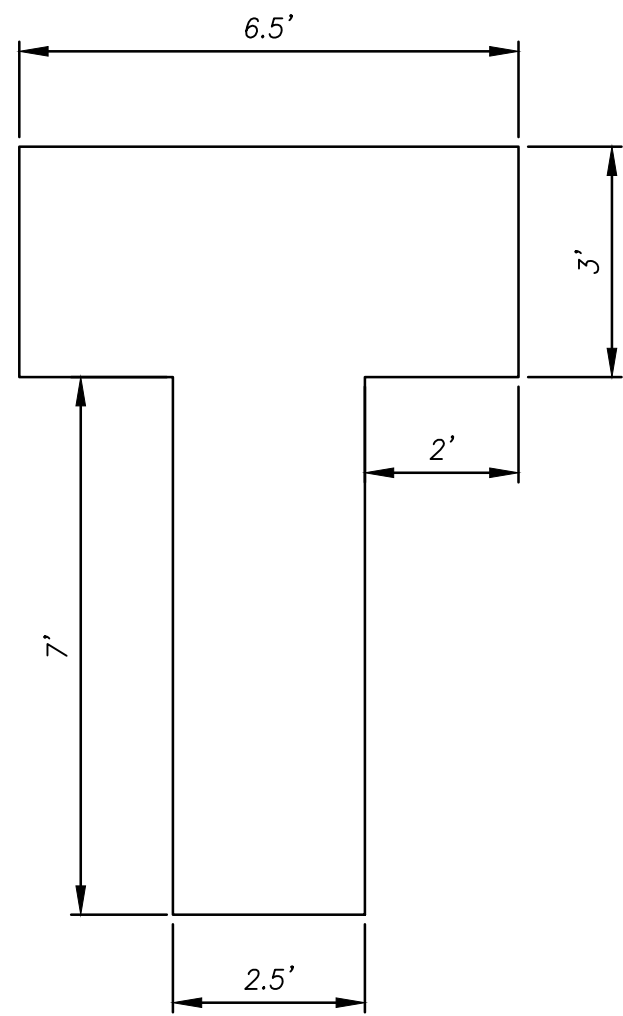

TRENCH #15 DIMENSIONS

NOT TO SCALE

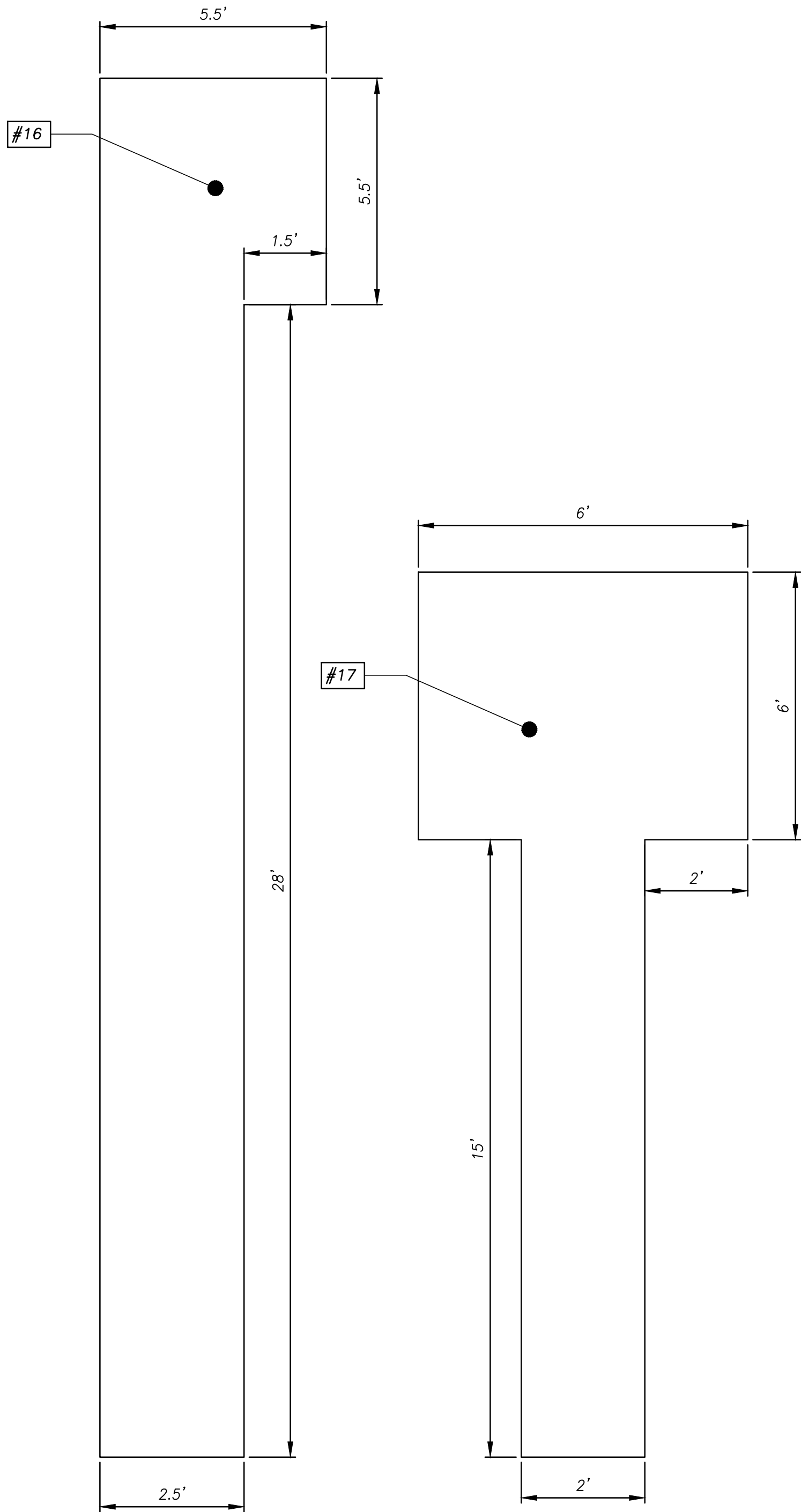

TRENCH #16 & #17 DIMENSIONS

NOT TO SCALE

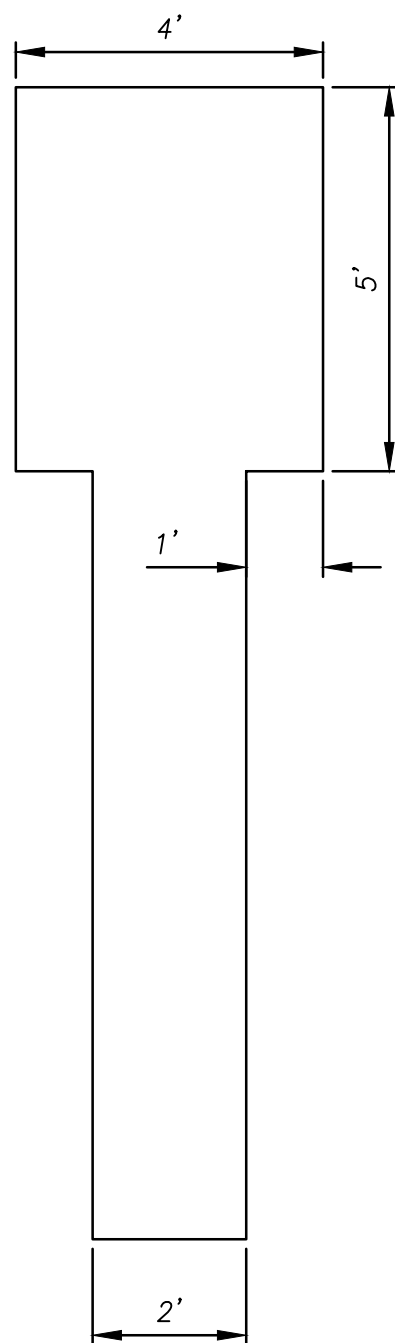

TRENCH #18 DIMENSIONS

NOT TO SCALE

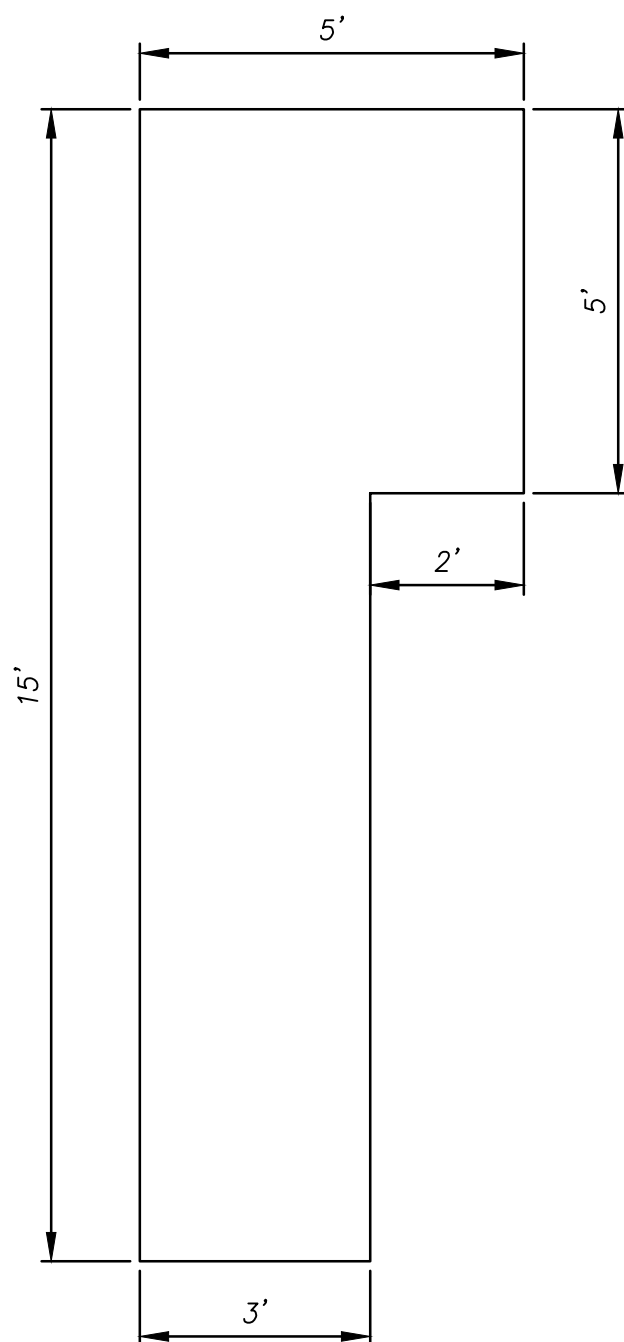

TRENCH #19 DIMENSIONS

NOT TO SCALE

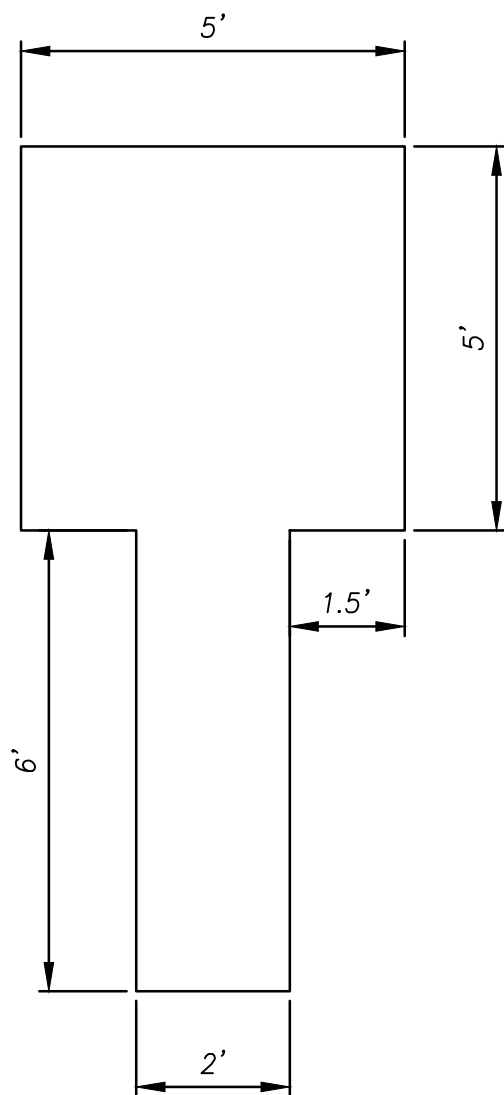

TRENCH #20 DIMENSIONS

NOT TO SCALE

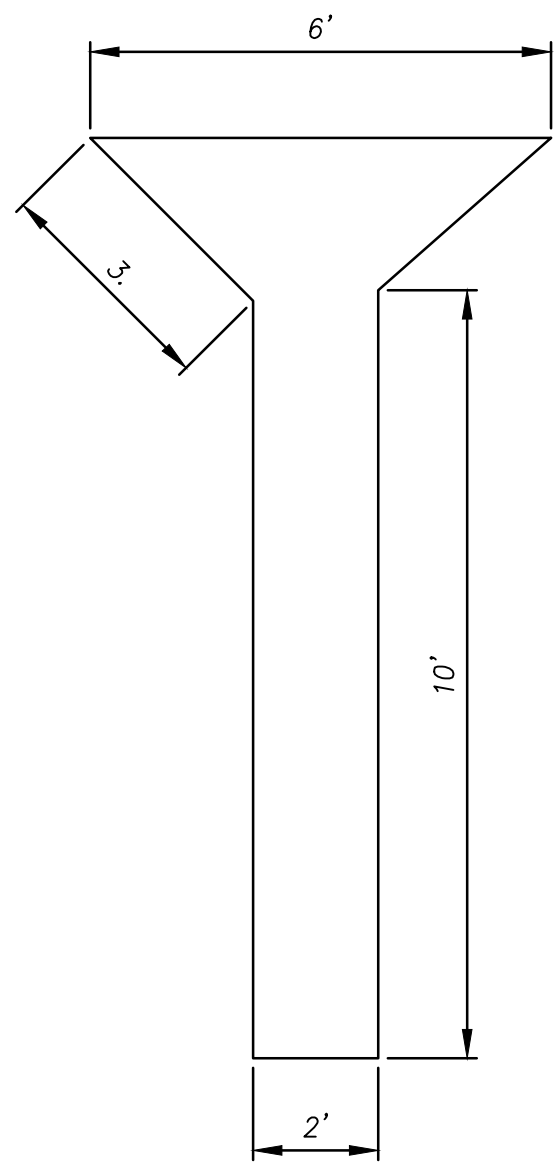

TRENCH #21 DIMENSIONS

NOT TO SCALE



NOTE:
ALL REFERENCES AND WRITTEN
DIMENSIONS SHALL SUPERCEDE
ALL SCALED DISTANCES AND
SHALL BE VERIFIED IN THE
FIELD. ANY DISCREPANCY SHALL
BE BROUGHT TO THE ATTENTION
OF THE ENGINEER PRIOR TO
THE COMMENCEMENT OF WORK.

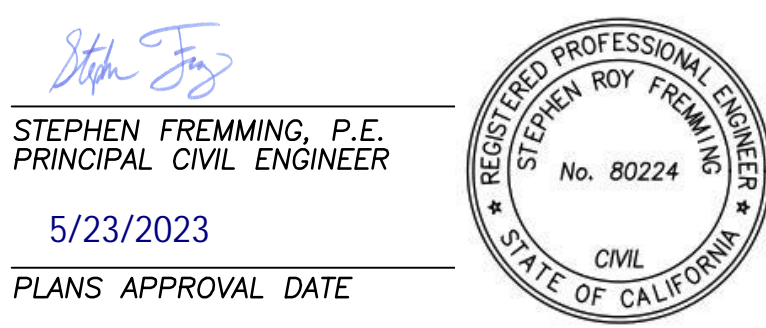

CITY OF TURLOCK
PUBLIC WORKS DEPARTMENT
ENGINEERING DIVISION
156 S. BROADWAY, STE 150
(209) 668-5520

TRENCHES WITH IRREGULAR DIMENSIONS
CAPITAL PROJECT NO. 21-023
CITY UTILITY TRENCH REPAIR - 2023

VERIFY SCALE
BAR IS 1" ON
ORIGINAL DRAWING
0 1/4" 3/4" 1"
1/2"
IF NOT ONE INCH ON
THIS SHEET, ADJUST
SCALES ACCORDINGLY

DRAWN BY: JTL
REV. BY: SRF
CH. BY: SRF
DATE: MAY 16, 2023
SCALE: NOT TO SCALE
21-023 DRAWINGS.DWG

SHEET
03
OF 04

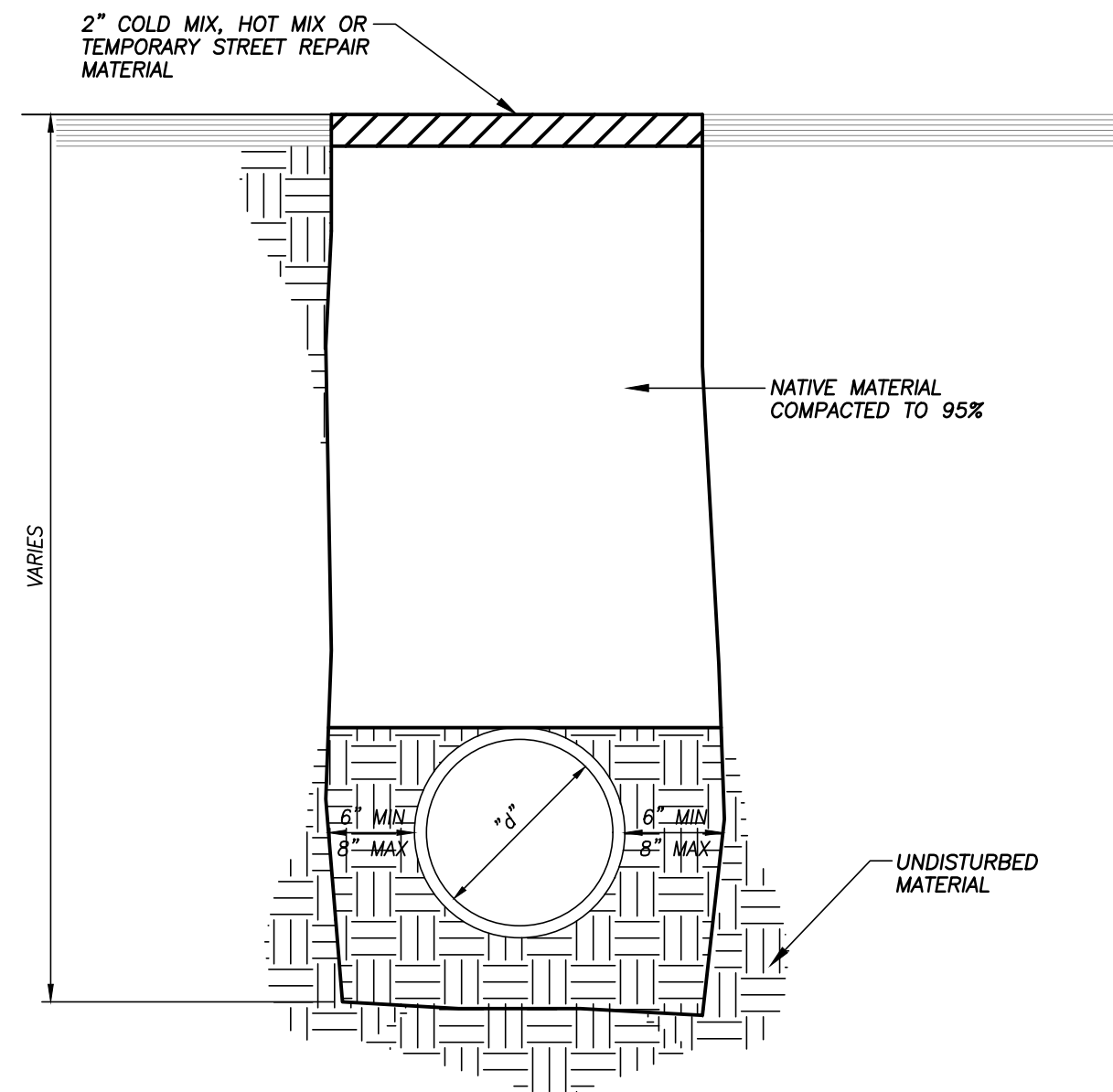

- NOTES:
1. COMPACTION TESTS SHALL BE APPROVED BY THE CITY BEFORE PAVING.
 2. TRENCHES 5 FEET OR MORE IN DEPTH SHALL BE SHORED.
 3. MAXIMUM LIFT THICKNESS FOR BEDDING AND BACKFILL SHALL BE 12" BEFORE COMPACTION.
 4. TRENCHES WHICH ARE LESS THAN 30" IN DEPTH OR LESS THAN 18" IN WIDTH SHALL BE BACKFILLED WITH TWO SACK CEMENT SLURRY.
 5. ALL STEPS OF TRENCHING SHALL BE REPEATED WHEN REPAIRING A SECTION OF PIPE.

3 STEP TRENCH REPAIR – STEP 1 (MODIFIED CITY STANDARD DETAIL T-1)

NOT TO SCALE

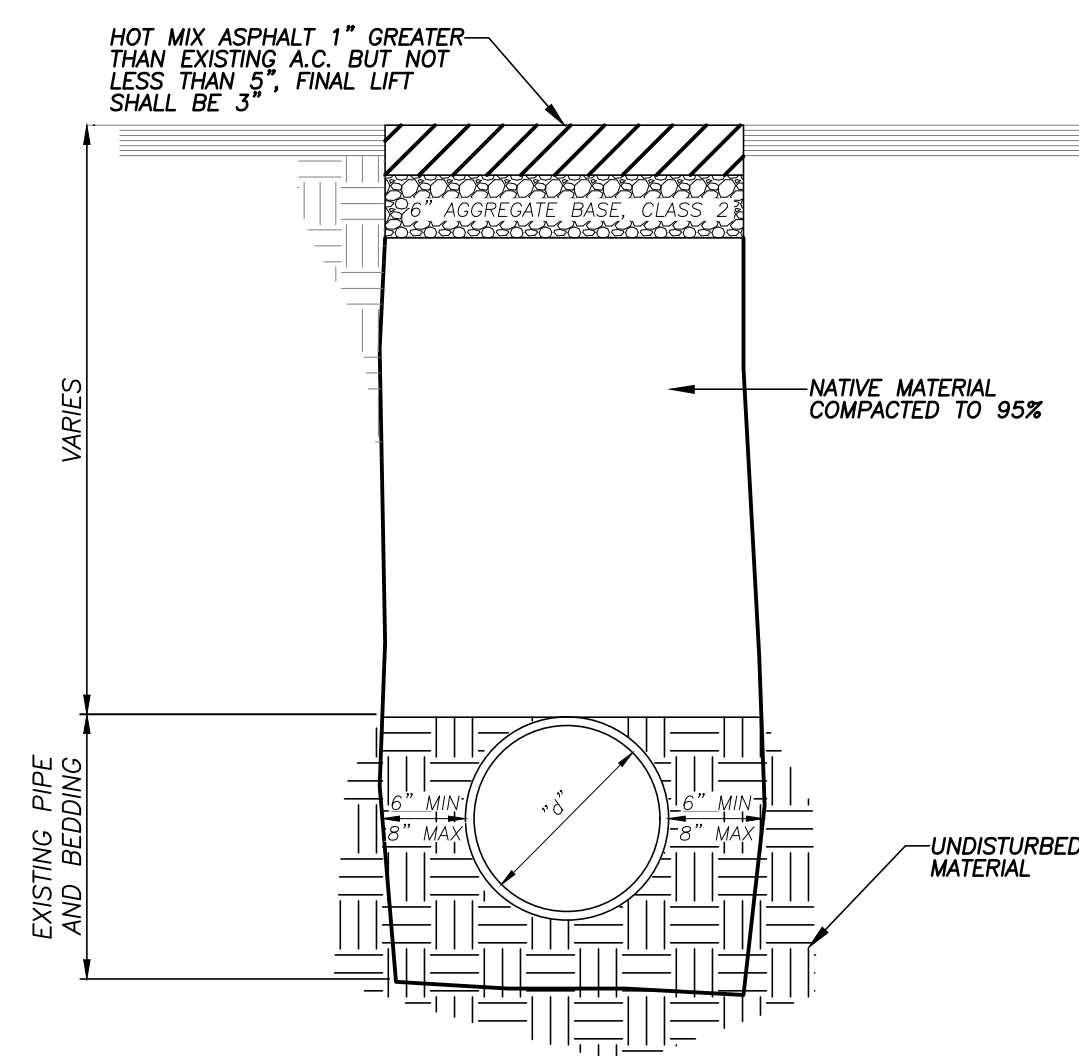

- NOTES:
1. DWG NO. T-1 MAY BE OMITTED IF DWG NO. T-2 IS PERFORMED ON THE SAME DAY AS THE TRENCH EXCAVATION.
 2. COMPACTION TESTS SHALL BE APPROVED BY THE CITY BEFORE PAVING.
 3. TRENCHES 5 FEET OR MORE IN DEPTH SHALL BE SHORED.
 4. MAXIMUM LIFT THICKNESS FOR BEDDING AND BACKFILL SHALL BE 12" BEFORE COMPACTION.
 5. TRENCHES WHICH ARE LESS THAN 30" IN DEPTH OR LESS THAN 18" IN WIDTH SHALL BE BACKFILLED WITH TWO SACK CEMENT SLURRY.
 6. ALL STEPS OF TRENCHING SHALL BE REPEATED WHEN REPAIRING A SECTION OF PIPE.
 7. HMA SHALL BE PG 64-10, TYPE A

3 STEP TRENCH REPAIR – STEP 2 (MODIFIED CITY STANDARD DETAIL T-2)

NOT TO SCALE

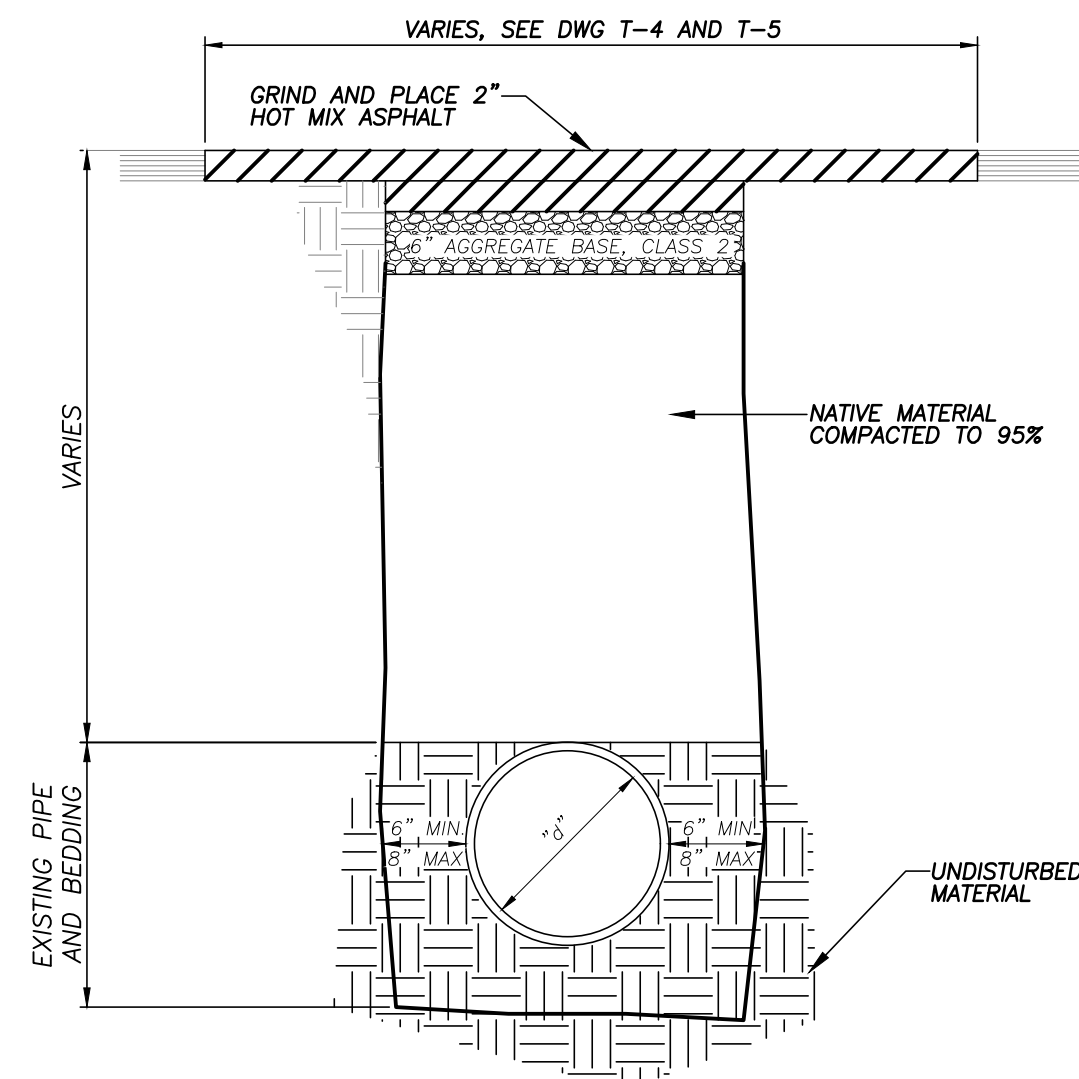

- NOTES:
1. COMPACTION TESTS SHALL BE APPROVED BY THE CITY BEFORE PAVING.
 2. TRENCHES 5 FEET OR MORE IN DEPTH SHALL BE SHORED.
 3. MAXIMUM LIFT THICKNESS FOR BEDDING AND BACKFILL SHALL BE 12" BEFORE COMPACTION.
 4. TRENCHES WHICH ARE LESS THAN 30" IN DEPTH OR LESS THAN 18" IN WIDTH SHALL BE BACKFILLED WITH TWO SACK CEMENT SLURRY.
 5. ALL STEPS OF TRENCHING SHALL BE REPEATED WHEN REPAIRING A SECTION OF PIPE.

3 STEP TRENCH REPAIR – STEP 3 (MODIFIED CITY STANDARD DETAIL T-3)

NOT TO SCALE

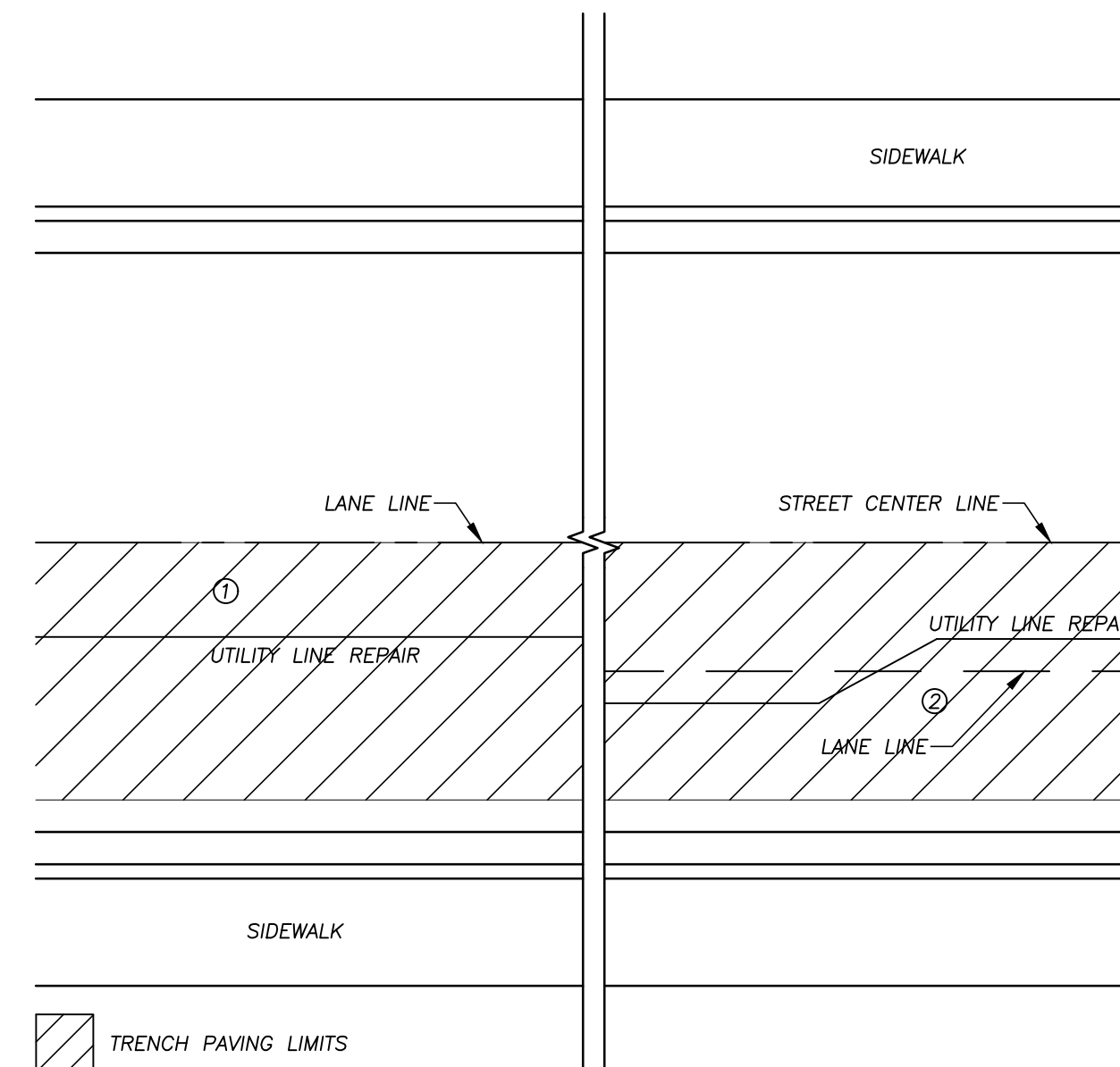

- NOTES:
1. GRINDING AND FINAL PAVING WIDTH SHALL BE TO THE EXTENT OF AFFECTED LANE LINES, 12' MIN.
 2. IF TRENCH CROSSES LANE LINES, GRINDING AND FINAL PAVING WIDTH SHALL BE TO THE EXTENT OF ALL AFFECTED LANE LINES FOR ENTIRE LENGTH OF TRENCH

LONGITUDINAL TRENCH PATCH LIMITS

	DRAWN BY: JSH	CITY OF TURLOCK APPROVED BY: INTERIM CITY ENGINEER – NATHAN B. BRAY – RCE 76642	DRAWING NO. T-4
	CHECK BY: NBB		COUNCIL APPROVAL
	SCALE: NONE		FEB, 2019

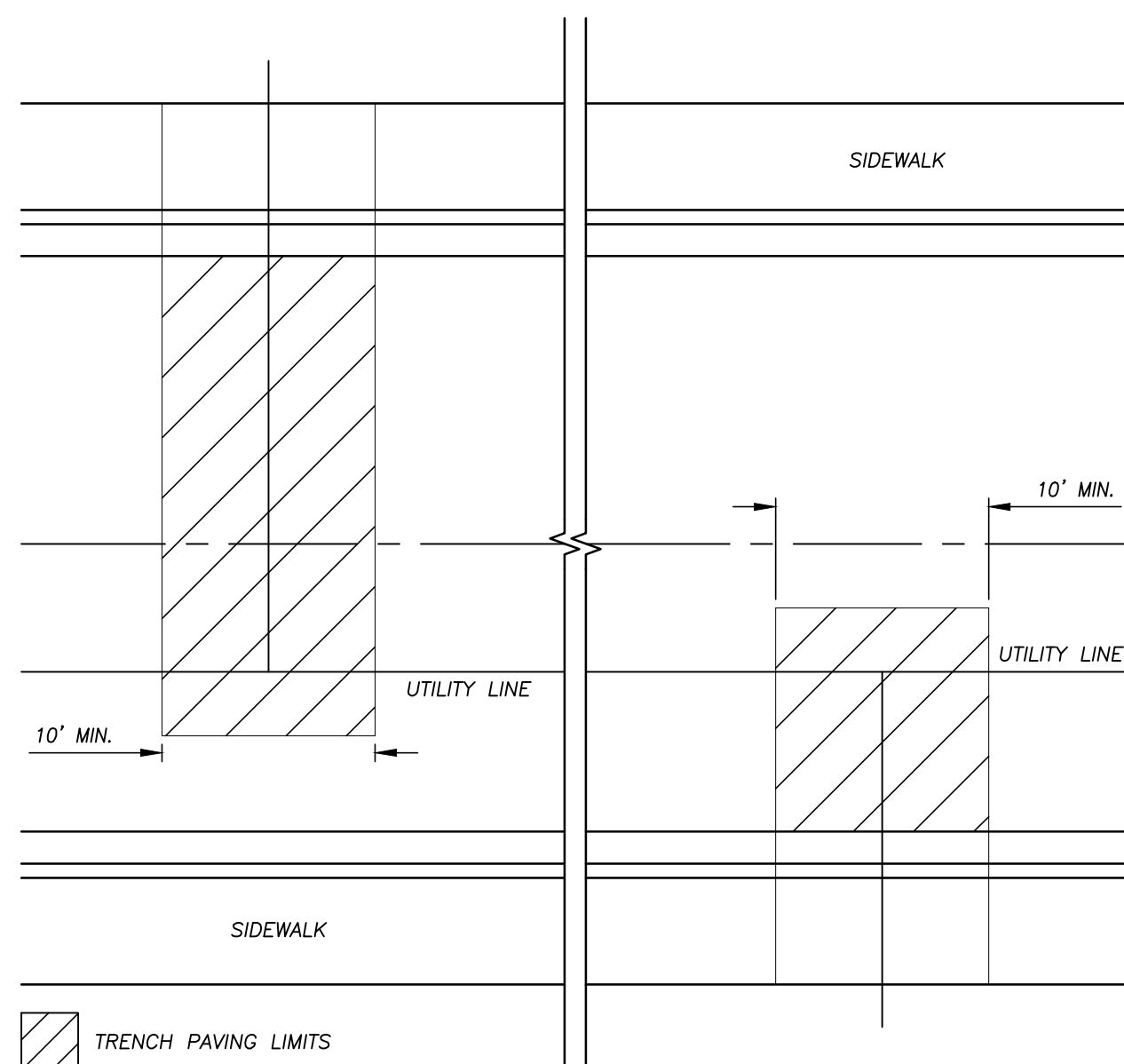

- NOTES:
1. GRINDING AND PAVING WIDTH SHALL BE 10' MIN.
 2. ALL CUTS SHALL BE SQUARE AND PERPENDICULAR TO THE TRAVEL LANE

PERPENDICULAR TRENCH PATCH LIMITS

	DRAWN BY: JSH	CITY OF TURLOCK APPROVED BY: INTERIM CITY ENGINEER – NATHAN B. BRAY – RCE 76642	DRAWING NO. T-5
	CHECK BY: NBB		COUNCIL APPROVAL
	SCALE: NONE		FEB, 2019

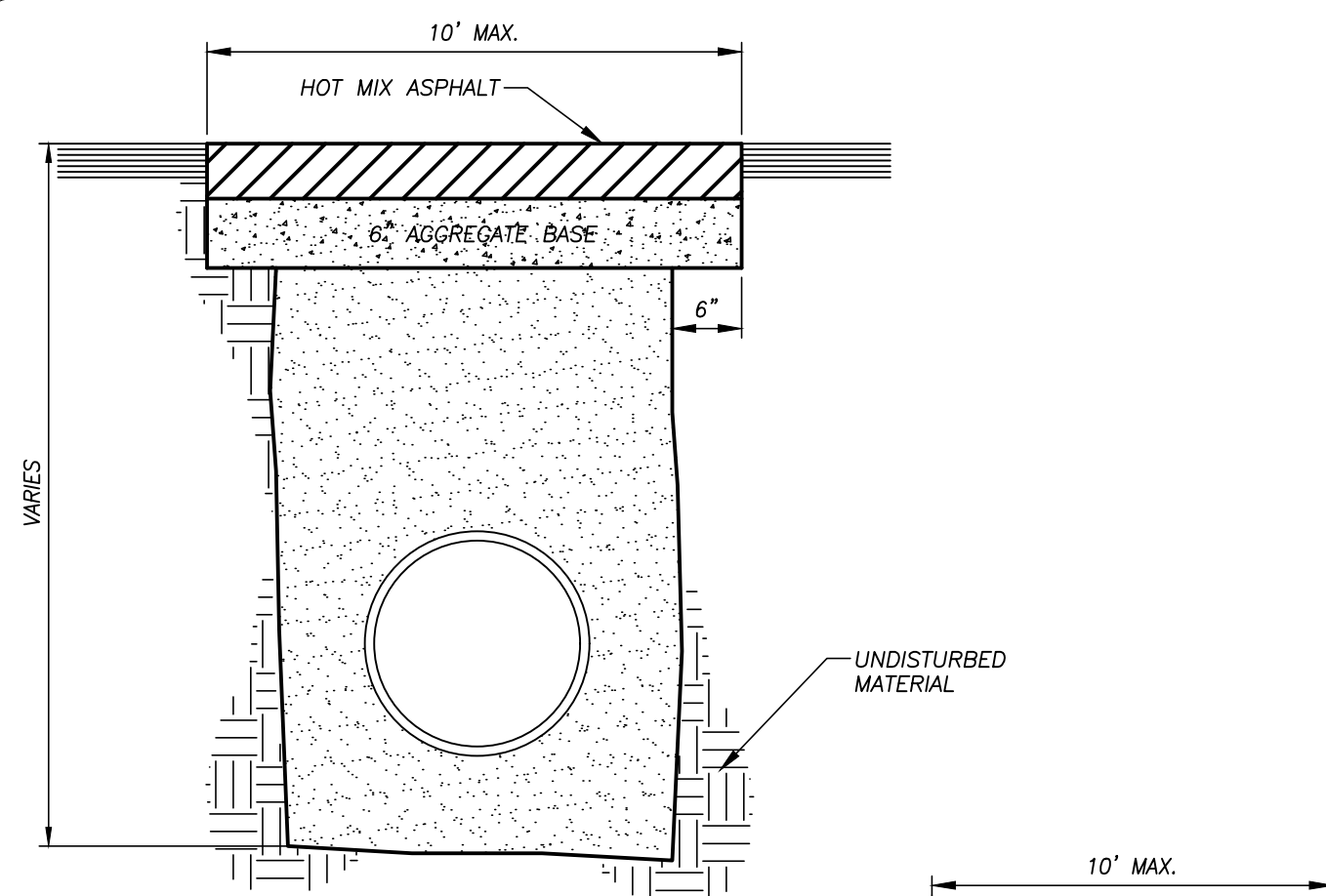

PROFILE

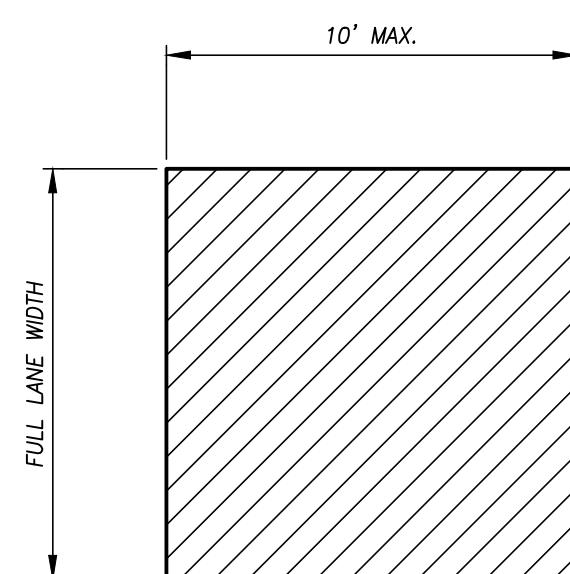

PLAN

- NOTES:
1. HMA SHALL BE 1" GREATER THAN EXISTING, 5" MIN.
 2. LIFT THICKNESS SHALL BE 2" TO 3"
 3. HMA SHALL BE PG 64-10, TYPE A
 4. FINAL LIFT SHALL BE COMPACTED WITH A VIBRATORY ROLLER

BELL HOLE PATCH

	DRAWN BY: JSH	CITY OF TURLOCK APPROVED BY: INTERIM CITY ENGINEER – NATHAN B. BRAY – RCE 76642	DRAWING NO. T-6
	CHECK BY: NBB		COUNCIL APPROVAL
	SCALE: NONE		FEB, 2019



NOTE:
ALL REFERENCES AND WRITTEN DIMENSIONS SHALL SUPERCEDE ALL SCALED DISTANCES AND SHALL BE VERIFIED IN THE FIELD. ANY DISCREPANCY SHALL BE BROUGHT TO THE ATTENTION OF THE ENGINEER PRIOR TO THE COMMENCEMENT OF WORK.

STEPHEN FREMMING, P.E.
PRINCIPAL CIVIL ENGINEER
5/23/2023
PLANS APPROVAL DATE



CITY OF TURLOCK
PUBLIC WORKS DEPARTMENT
ENGINEERING DIVISION
156 S. BROADWAY, STE 150
(209) 668-5520

CONSTRUCTION DETAILS
CAPITAL PROJECT NO. 21-023
CITY UTILITY TRENCH REPAIR – 2023

VERIFY SCALE
BAR IS 1" ON ORIGINAL DRAWING
1/4" 3/4" 1"
0 1/2"
IF NOT ONE INCH ON THIS SHEET, ADJUST SCALES ACCORDINGLY

DRAWN BY: JTL
REV. BY: SRF
CH. BY: SRF
DATE: MAY 16, 2023
SCALE: NOT TO SCALE
21-023 DRAWINGS.DWG

SHEET

04
OF 04